



Knowledgebase > Software > Students > Installing Creative Cloud App for Mac and PC (Student)

## Installing Creative Cloud App for Mac and PC (Student)

Ulrich Sommerauer - 2021-02-02 - Comments (0) - Students

### Installing Creative Cloud App for Mac and PC

Open the browser of your choice (Chrome, FireFox, Safari or Edge) and navigate to [www.adobe.com](http://www.adobe.com)

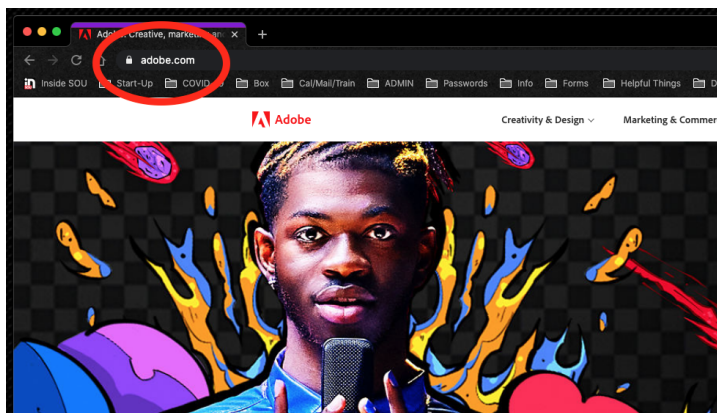

Sign in

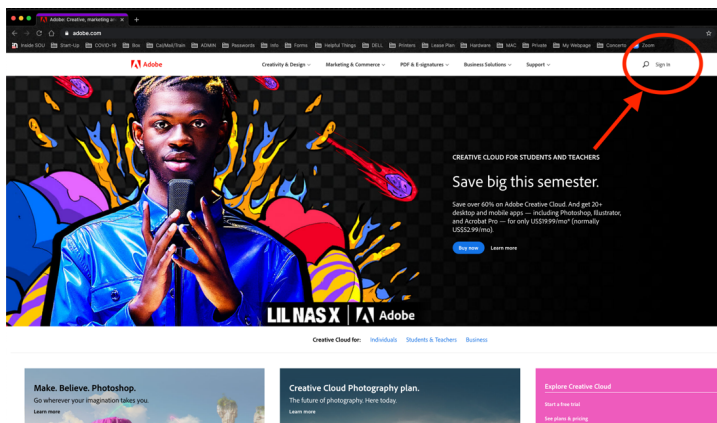

Use your SOU email (Not your private one, this is important)

**Sign in**  
New user? [Create an account](#)

Email address  
sommerau@sou.edu

Continue

Or

Continue with Google

Continue with Facebook

Continue with Apple

Protected by reCAPTCHA and subject to the Google [Privacy Policy](#) and [Terms of Service](#)

You will be redirected to our login prompt, if not, something is wrong. Stop right there and start over ☐



#### SOU Shibboleth Login Services

Username  
sommerau

Password  
\*\*\*\*\*

Login

By logging into inside.sou.edu, you are agreeing to SOU's Computing Resources Acceptable Use Policy.

**Need Help?**

- [Forgot your password?](#)
- For help with password resets or login issues, contact the IT Help Desk at 541-552-6900 or [helpdesk@sou.edu](mailto:helpdesk@sou.edu).

After you successfully logged in, locate the Creative Cloud link and click it.

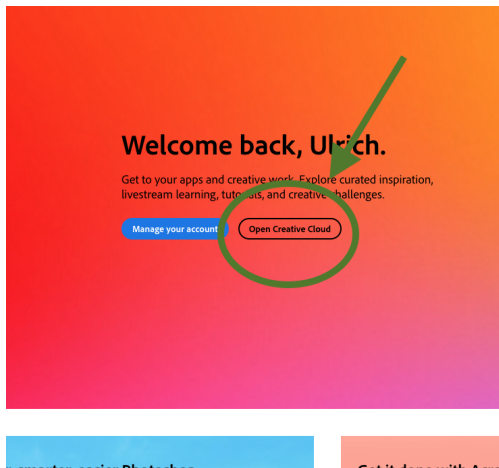

Find the other Creative Cloud link and also click it

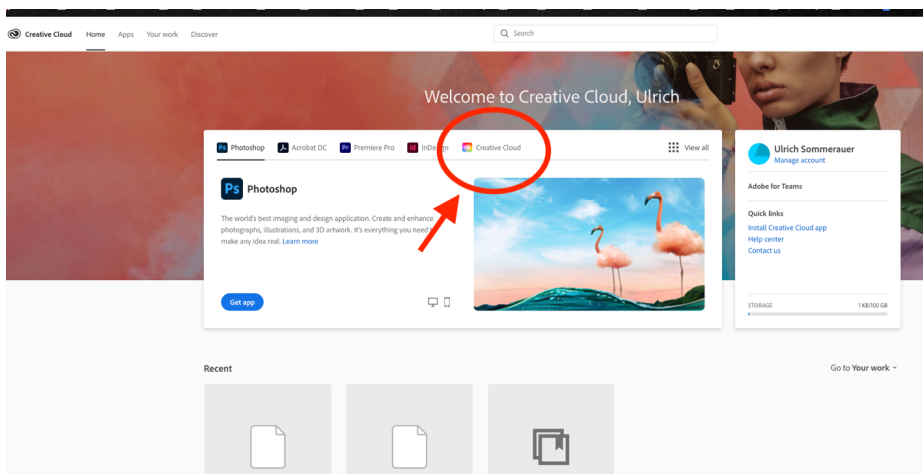

Click there, then download the App

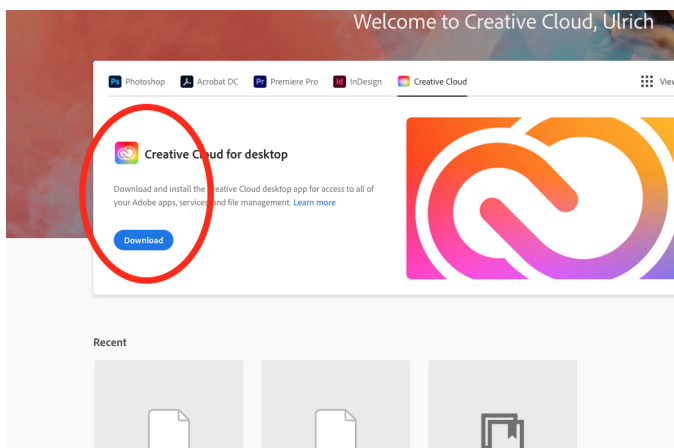

Install the App. Once installed you will be asked to sign in (unless you still have the web interface open). After you gain access you can pick any of

the Apps in the Apps section to download and install.

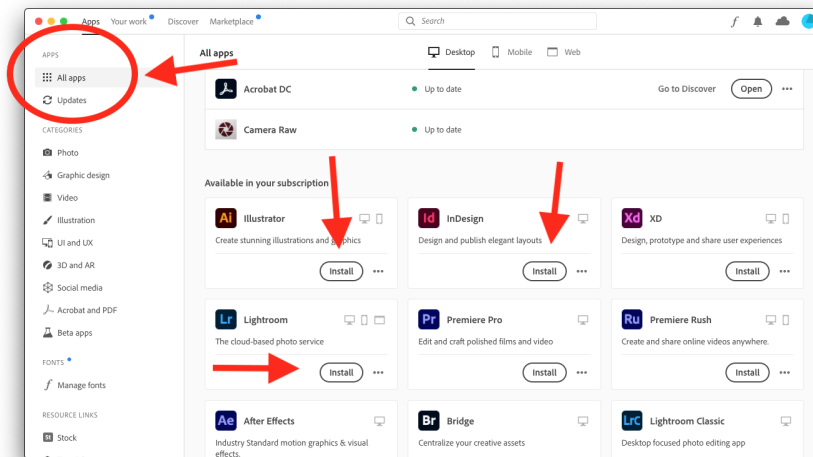

I highly recommend only installing the Apps that you need ... the entire suite takes up quite a chunk of your local storage.

As a student, the license will be good until the end of the term that you are enrolled in. If you do enroll in another course after that, that also has Adobe privileges, the license will simply continue.